

Integral Ballast System

SportsLiter Solutions

SportsLiter® Solutions Systems is an integrated modular lighting system designed to meet the demanding requirements of today's sports lighting specifications. Each system includes pre-wired pole top crossarms (wired to junction boxes and distribution blocks), pre-wired integral ballast luminaires with optics and lamps, professional lighting designs and installation help. Steel or concrete poles are included and are matched to the wind zone and luminaire quantity per location. This engineered system is designed to work together guaranteeing performance and long, trouble-free operation.

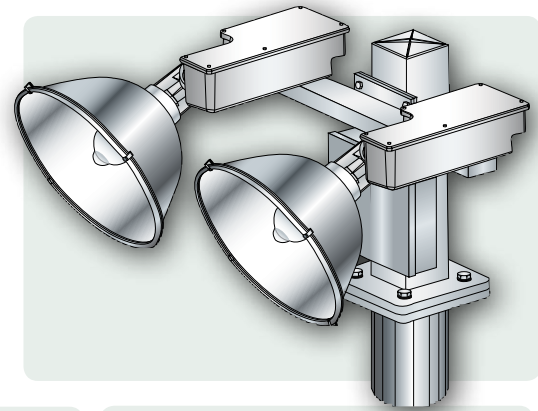

SPORTSLIGHTING

SYSTEM CONFIGURATION

A) Pole Top Crossarm Assembly

- Pre-wired to distribution blocks
- Junction box included for wiring connections (hot-dip galvanized)
- Hot-dip galvanized steel crossarm
- Mounting hardware included
- Labeled with pole reference
- Labeled with optic type
- Tubular steel crossarms
- UL listed/ CSA certified
- Steel and concrete pole mounting options
- Base plate or clamp-on mount available
- 100% electrically tested at factory
- Strain relief support included
- Fillet type welds
- Ground lug included
- Single-phase wired 2-6 luminaires
- Three-phase wired 7-18 luminaires

B) Integral Ballasted Luminaire

- Die-cast aluminum housing
- Pre-wired with cord/plug set
- Isolated ballast compartment from lamp
- Stainless steel lens ring
- Silicone gasketing
- Filtered optics
- Built in lamp support
- Isolated wiring chamber
- Hubbell Gard™ treated hardware
- Lektrocote® polyester powder paint
- Horizontal and vertical aiming indicators
- Environmental spill/ glare control optional
- Mounting hardware included
- Fast Aim™ system
- Repositioning stop
- Thermal shock, impact resistant tempered lens
- Stainless steel hinge
- Four point stainless steel lens latching
- Aiming sights included
- UL listed and CSA certified
- Note, luminaires must be aimed at site
- Rated for 40°C ambient operation

C) Direct Embedded Steel Poles

- Hot-dip galvanized finish
- System matched to luminaires
- Shipped in sections
- Protective coating (below grade to 6" above)
- Ground lug included
- Power cord support hangers (cord by others)

Concrete Poles

- Centrifugal spun
- Pre-stressed
- System matched to luminaires
- Shipped as single piece
- Ground lug included
- Harness support hangers
- Smooth, natural finish

Anchor Base Steel Poles

- Hot-dip galvanized finish
- System matched to luminaires
- Shipped in sections
- Anchor bolts and templates included
- Ground lug included
- Drop cord support hangers (cord by others)

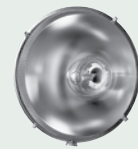

Axial Optic



Horizontal Optic

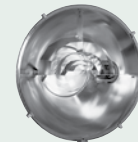

Spill/ Glare Optic



"SGV2"
Spill/ Glare Optic
with Visor



LV Option



Poles

